

EXTERIOR VIEW

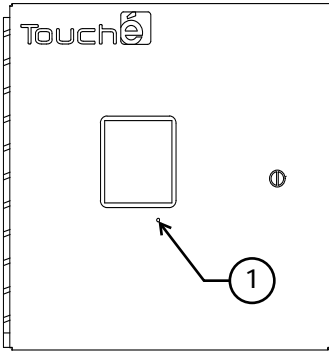

TIPS / NOTES

1. COMMUNICATION LED - DISPLAYS STATUS OF BRANCH COMMUNICATION. SOLID BLUE OR BLINKING BLUE = COMMUNICATION ACTIVE
2. TOUCHÉ eNET PORTS - MINIMUM CAT5 CABLE - CONNECT TO TOUCHÉ eNET DEVICES ONLY. NOTE THAT RIGHT PORT WILL NOT FUNCTION WITHOUT ACTIVE CONNECTION IN LEFT PORT.
3. POWER STATUS INDICATOR - GREEN LED WHETHER MASTER INTERFACE IS USING NORMAL OR BATTERY POWER
4. BRANCH POWER SOURCE PROTECTION FUSE - BUILT-IN PROTECTION FOR BRANCH POWER-SOURCE CIRCUITRY.
5. 27VDC POWER OUTPUT - MINIMUM 16/2 CABLE - SUPPLIES REQUIRED VOLTAGE TO POWER SPLITTER/BOOSTERS AND/OR TSUI'S
6. PRIMARY BRANCH PORT - MINIMUM CAT5 CABLE - SUPPLIES POWER AND COMMUNICATION TO BRANCH DEVICES SUCH - DO NOT CONNECT TO RM'S
7. BACKUP BATTERY PORT - USE THE PROVIDED CABLE TO WIRE BATTERIES IN SERIES
8. 120/277VAC POWER INPUT - USE ORANGE WAGO CONNECTOR FOR INPUT TO POWER SUPPLY - DO NOT WIRE NUT HIGH VOLTAGE WIRING INTO MASTER INTERFACE

INTERIOR VIEW

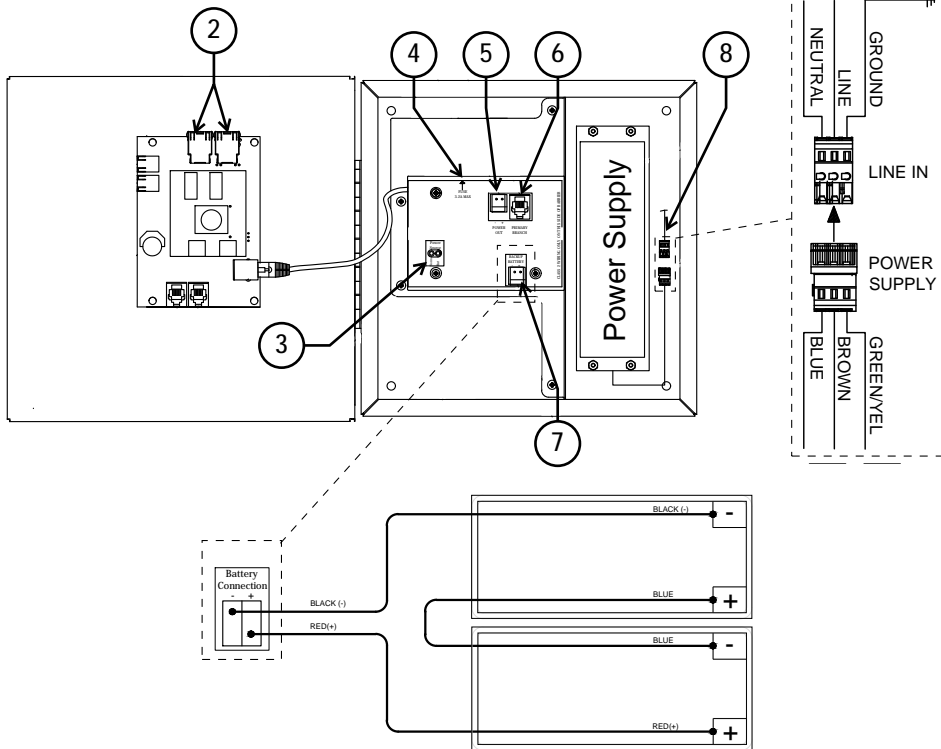

CONDUIT PENETRATION LOCATIONS

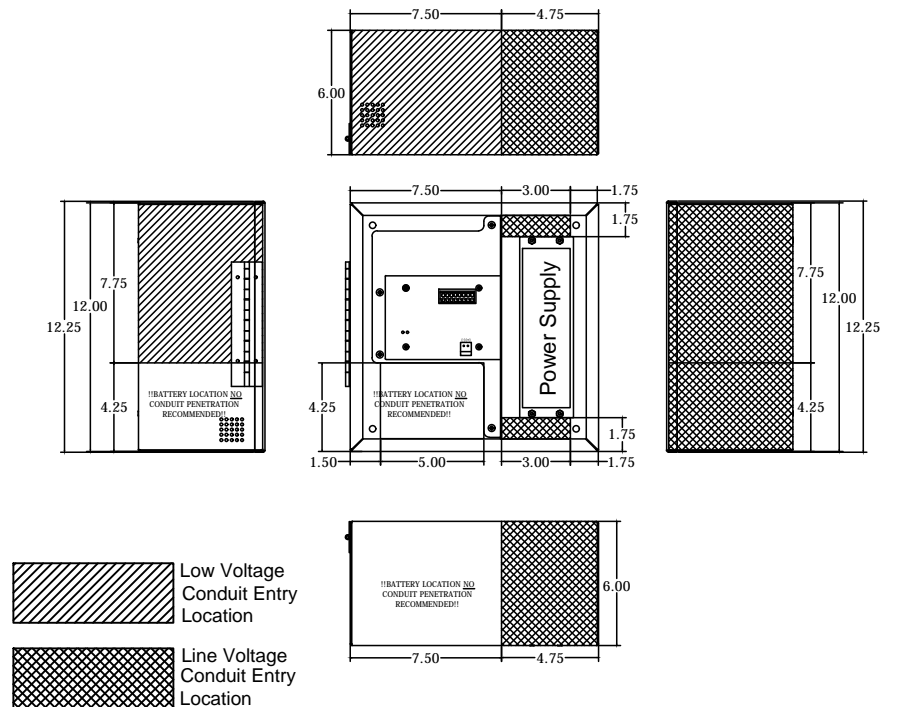

CONNECTIVITY DIAGRAM

COMPONENT LIST

1. MSTR-DVOLT-2 (DOOR OPEN)
2. SBB1
3. LRM OR LIM
4. RD PANEL
5. SW-TS-M
6. SMOAS
7. TSUI
8. RM
9. WS-TS-C
10. SS-2B
11. SS-SF

CABLE LEGEND

- = éNET (CAT5)
- - - - - = BRANCH NETWORK (CAT 5)
- · - · - = SMART NETWORK (CAT 5)
- = 16/2 POWER CABLE

NOTE: ALL COMPONENTS MAY NOT BE PRESENT. DIAGRAM IS ONLY INTENDED TO SHOW CONNECTION POINTS BETWEEN COMPONENTS

